

SR2000

USER GUIDE

Congratulations on your purchase of this Tru-Test Series 2000 scale Indicator. To ensure you receive the service you are entitled to, please complete and post the warranty card without delay.

WITH THE SR2000 YOU CAN . . .

- Access the built-in manual where and when you need it.
- Display several items on the Weigh screen at once (eg. weight, tag/ID & gain).
- Move animals quickly from one file to another.
- See how much weighing time is left when running on the internal battery.
- Enter alpha-numeric tags/IDs, condition codes and file names (eg. for tag colour and easily recognisable file names).
- See weight gains (total, daily, monthly, total %, daily %, monthly %) to allow individual and group performance to be evaluated.
- See carcass weight.
- See dollar value (carcass or live weight) across 3 payout schedules.
- Perform 3-way drafting/sorting by weight, weight gain, carcass weight or value.
- Use automatic weight recording for hands free weighing and recording.
- Interface with EID and auto drafting/sorting equipment.
- Enter 2 condition codes for detailed information on individual animal performance.
- Print reports that include carcass weights, weight gains and values.
- Span calibrate, allowing the SR2000 to be used with any loadcells.
- Perform group weighing.
- Perform reverse weighing.

INSTALLATION

- 1 Install loadbars/EziFeet under the platform on a firm, level surface (see Loadbar User Manual).
- 2 Mount the Indicator bracket in a convenient place where animals can't knock the Indicator off or chew the cables. The bracket mounts onto flat surfaces (timber rails, concrete) or horizontal pipe-work with the supplied U-bolts.
- 3 Connect loadbar/EziFeet cable(s) to the Indicator. Connect dust caps as shown. The Indicator automatically calibrates itself to Tru-Test loadbars or EziFeet.
- 4 Connect power cable (if needed).

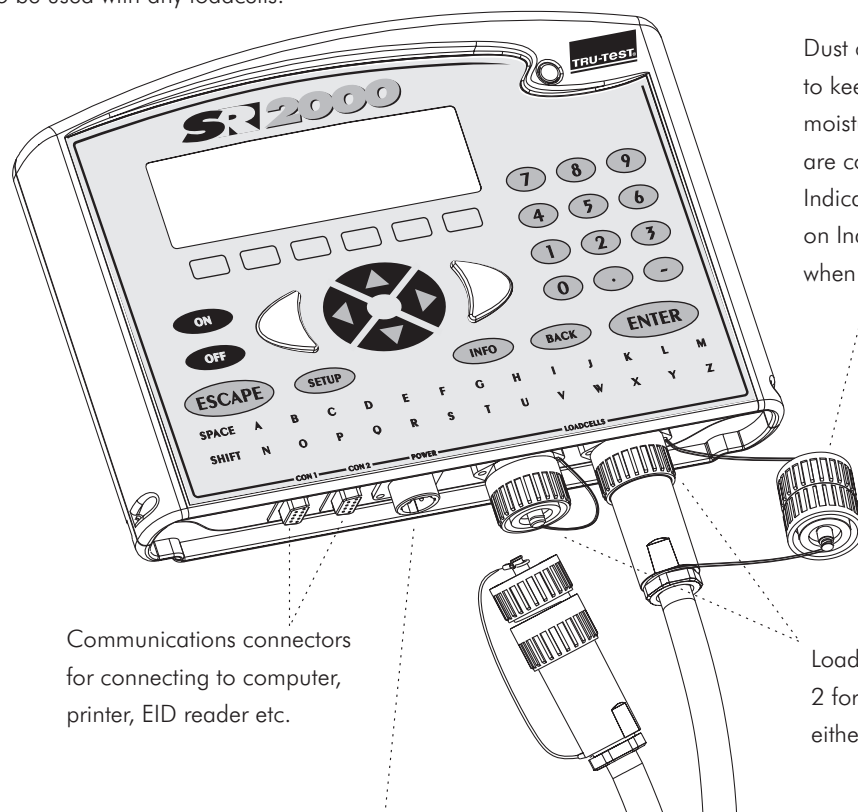

Dust caps screw together to keep out dirt and moisture when cables are connected to Indicator. Screw back on Indicator/cables when cables removed.

Communications connectors for connecting to computer, printer, EID reader etc.

Loadcell connectors, 2 for loadbars, use either 1 for EziFeet.

Power connector for connecting 12 V vehicle battery (red clip to positive terminal) or Tru-Test power adaptor. To connect power adaptor, pull battery clips off Indicator lead and plug lead into power adaptor lead (red to red).

FOR STARTERS

When first turned on the SR2000 takes you through an interactive tutorial to help familiarise you with the basic operation of the Indicator.

For full instructions on use of the Indicator, press **INFO** to view the built-in manual.

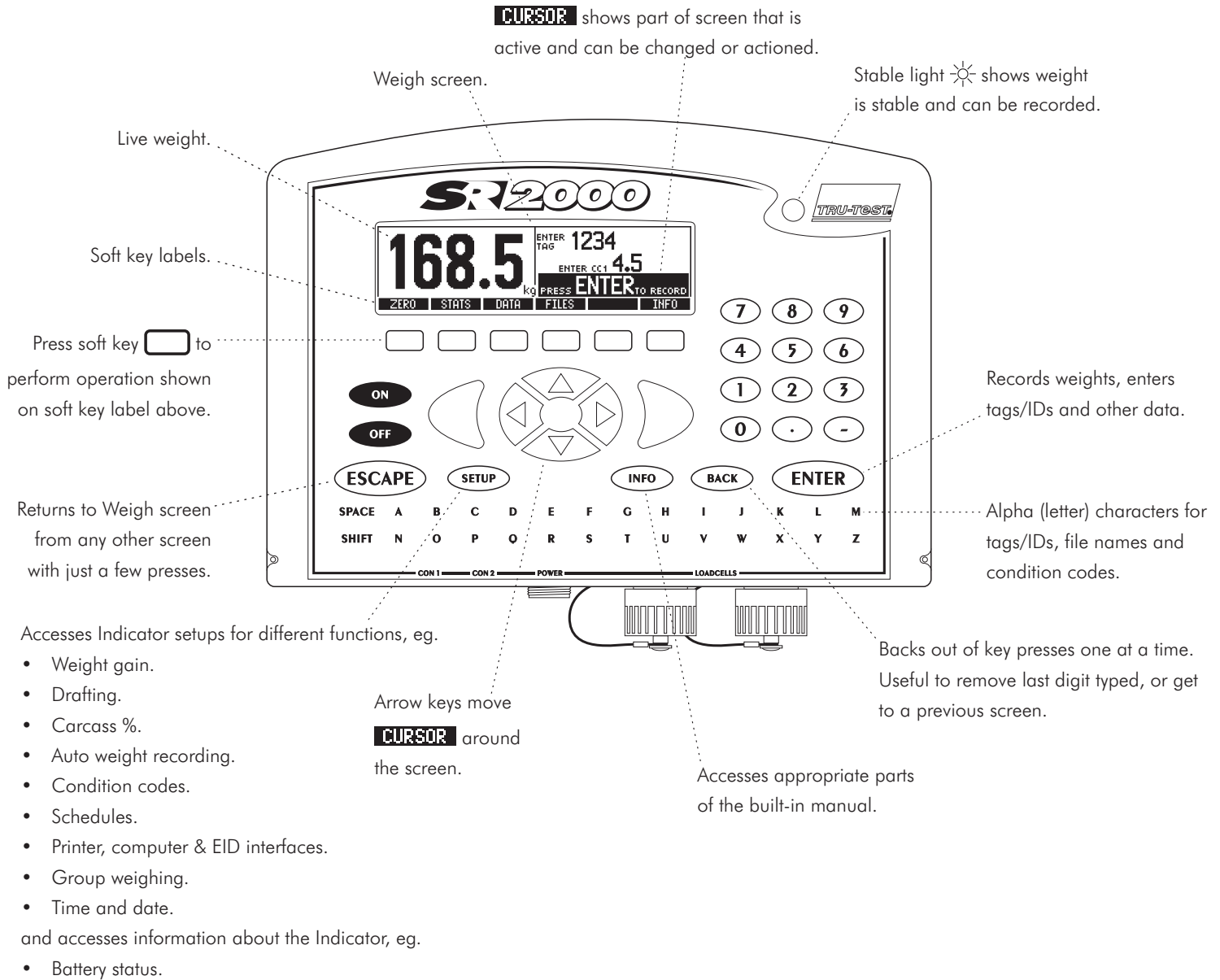

WEIGH SCREEN SOFT KEYS

- ZERO** Zeroes the scale after build up of dirt on the platform. Normally automatic.
- STATS** Displays average, total, minimum and maximum weights, gains etc.
- DATA** Displays animal records - Tag/ID, weight, condition codes, gain, carcass etc.
- FILES** Displays a list of files - for selecting new files or reviewing old ones.
- INFO** Takes you to the contents page of the built-in manual.

QUICK START (to record tag/ID and weight)

- 1 Press **ON** and wait for zero weight (if you see the Welcome screen, press **ENTER**).
 - 2 Move animal onto platform.
 - 3 Type in Tag/ID eg. **Y** **2** **9** **1**.
 - 4 Press **ENTER**.
 - 5 Wait for stable light ☀ and press **ENTER**.
- You have recorded Tag/ID and Weight. Move animal off platform and repeat from step 2.

TRICKS AND TIPS

For easy changing of files while weighing, put file number/name on Weigh screen.

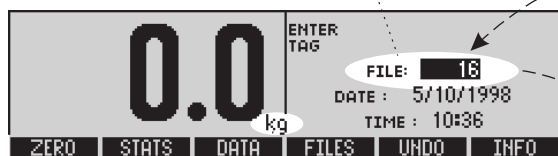

The Indicator is set to kg or lb in the factory. For some markets this can be changed.

To change

- Place **CURSOR** on kg/lb on Weigh screen.
- Press **ENTER**.
- Use arrow keys to select option.
- Press **ENTER** to accept.

To add an item to the Weigh screen

- Place **CURSOR** on an item in any screen.
- Press **INFO**.
- Place **CURSOR** on Put item on Weigh screen.
- Press **ENTER** to accept.

Short cut to File screen from Data/Statistics screens

- Place **CURSOR** here.
- Press **ENTER** to accept.

DATA TAG	File: 16	5/10/1998
	1265	278 kg
	1428	290 kg
	1287	288 kg
	1369	294 kg

TOP BOTTOM ORDER FIND PRINT

To remove an item from the Weigh screen

- Place **CURSOR** on item to remove.
- Press **INFO**.
- Place **CURSOR** on Remove from Weigh screen.
- Press **ENTER** to accept.

	INFO CONTENTS	INDEX
Tutorial	Info System	User Interface
Weigh screen	Basic Weighing	Recording
Tags	Condition Code	Data screen
Files	Drafting	Weight Gain
Printing	Setup	Value

To get back the Welcome screen/Tutorial

- Press **INFO** soft key.
- Place **CURSOR** on Tutorial.
- Press **ENTER** to accept.

OPERATING NOTES

During weighing, check that animals are fully on the platform.

Ensure that the underside of the platform or crate is kept clear of dirt and stones.

Do not leave the Indicator or loadbars/EziFeet in water. Store the Indicator in a cool dry place.

The Indicator automatically turns off after 15 minutes of no activity, to limit discharge of the internal/external battery. See **SETUP** to disable.

INTERNAL BATTERY OPTION

The internal battery charger operates from either the recommended Tru-Test power adaptor or a 12 volt vehicle battery. Damage to the Indicator caused by other charging supplies, including automotive battery chargers, is not covered by the warranty.

Charge the Indicator for 12 hours before using it for the first time.

The sophisticated battery modelling displays hours to run before flat (press **SETUP**, **BATTERY**), and also displays warning messages at 1 hour, 15 minutes and 1 minute before flat.

To maximise battery life, observe the following simple guidelines:

- Preferably recharge the battery overnight.
- Never charge the Indicator in direct sunlight.
- Store the Indicator in a cool dry place.

The internal battery charger ensures maximum life of the battery, while giving the fastest charging rate possible. The battery is protected from overcharging. Charging a flat battery takes 6 hours at temperatures of 10 °C to 35 °C (50 °F to 95 °F).

The 'Charge %' is displayed during charging to indicate charging progress.

You can safely leave the Indicator on charge all the time. The scale can be used while charging. You do not need to charge before storage.

Charging at low or high temperatures could extend the charging time to 12 hours. At extreme temperatures the Indicator will not charge.

Fully charge the Indicator after storage.

BRACKET INSTALLATION

Install on a horizontal pipe as shown, or attach to the wall using screws supplied.

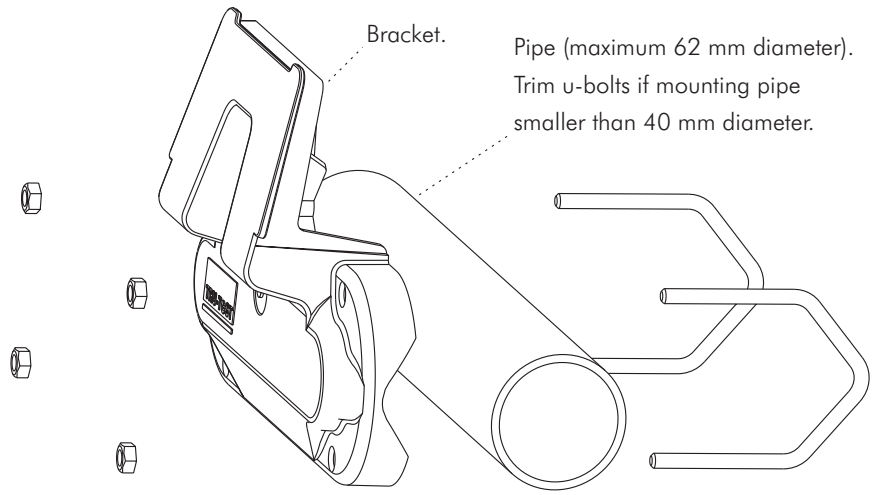

SPECIFICATIONS

Note: product specifications may change without prior notice.

Total Capacity	2000 kg or 3000 kg (4400 lb or 6600 lb) depending on loadbars/EziFeet used.
Resolution	Set to 0.5 kg (selectable 0.1 kg to 5 kg) or 1 lb (0.2 lb to 10 lb).
Accuracy	±1% or 2 resolutions (whichever is greater) with Tru-Test loadbars/EziFeet connected.
Power supply	12 V DC (power adaptor or vehicle battery).
Operating temperature	-10 °C to +40 °C (+14 °F to +104 °F).
Storage temperature	-20 °C to +35 °C (-4 °F to +95 °F).
Memory	10,000 records.
Internal battery run time	12 hours with 2 loadbars connected (10 hours with backlight on).
Communications	2 RS-232 connectors or RS-232 plus RS-485 connector.
Environmental	IP67 (immersion in 1 m of water).

FOR SERVICE

www.tru-test.com

New Zealand	Phone (09) 978 8888	Facsimile (09) 978 8889	Toll Free 0800 878 837
USA	Phone (210) 495 9130	Facsimile (210) 495 9129	Toll Free 1 800 874 8494
Australia Vic. S.A. Tas.	Phone (03) 5820 1800	Facsimile (03) 5831 5524	Toll Free 1 800 682 880
Qld. N.S.W. N.T.	Phone (07) 3274 7800	Facsimile (07) 3255 6454	Toll Free 1 800 682 880
W.A.	Phone (08) 9274 1122	Facsimile (08) 9274 4824	Toll Free 1 800 682 880
UK	Phone (01765) 689 541	Facsimile (01765) 689 851	
Ireland	Phone (021) 334 066	Facsimile (021) 334 520	
Denmark	Phone 45 800 922	Facsimile 45 800 999	
Hungary	Phone (23) 414 100		
Czech Republic	Phone (5) 4721 5729		
Poland	Phone (22) 645 1247		
Latvia	Phone 2945 796	E-mail doma@sal.lv	
Lithuania	Phone 2790 034	E-mail vildoma@lpc.lt	
Estonia	Phone 7362 716	E-mail estdoma@kodu.ee	

FCC NOTICE

The Tru-Test Model SR2000 Indicator has been tested and found to comply with the limits for a Class A digital device, pursuant to Part 15 of the FCC rules. These limits are designed to provide reasonable protection against harmful interference when the equipment is used in a commercial environment. This equipment generates, uses and can radiate radio frequency energy and, if not installed and used in accordance with the instruction leaflet, may cause harmful interference to radio communications. Operation of this equipment in a residential area is likely to cause harmful interference, in which case users will be required to correct the interference at their own expense.



© Tru-Test Limited, 2000
Auckland, New Zealand, www.tru-test.com
An ISO 9001 Quality Registered Company

WID80001 English rev 3 11.00